



RHODES
ARCHITECTURAL
STONE
NATURAL STONE EXPERTS

HAWTHORNE HOUSE

Positioned on one of the most desirable lots in Aspen, this exquisite work of modern architecture is a contemporary masterpiece. An adze hand-finished pathway and entry stairs lead to the front entry reflection pond encased in Golden Dune Granite. Just beyond, the sunken garden water feature boasts solid Golden Dune Granite blocks with hand-carved water channels.

Modern and ancient details stand juxtaposed: Colossal windows are framed by oversized New Pearl Limestone wall veneer in a blend of

12th century hand-finished textures - point stalk and coarse adze.

Standing on commercial-grade construction with a steel substructure, the interior continues its grand scale with immense wall veneers accented by a three-level stair hall and monumental three-sided fireplace, all hand finished in fine adze.

Every stone element was hand crafted to custom specifications, labelled and diagrammed in assembly drawings, ensuring a seamless journey from design to fulfillment.



PROJECT PRINCIPALS

ARCHITECT
Poss Architecture + Planning and Interior Design

PHOTOGRAPHER
Michael Brands



UNITED STATES OF AMERICA
TEL +1 206 709 3000

AUSTRALIA
TEL +61 3 8199 9555

CHINA
TEL +86 592 533 0273

rhodes-stone.com
info@rhodes-stone.com

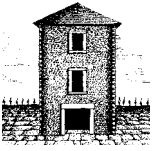

RHODES
ARCHITECTURAL
STONE
NATURAL STONE EXPERTS

HAWTHORNE HOUSE



PROJECT MATERIALS

NEW PEARL LIMESTONE
Wall veneer, quoins, hearth, lintels, sills

GOLDEN DUNE GRANITE
Hand-carved weir, coping, stepping stones,
pavers, wall caps, curbs, counter tops,
water wall

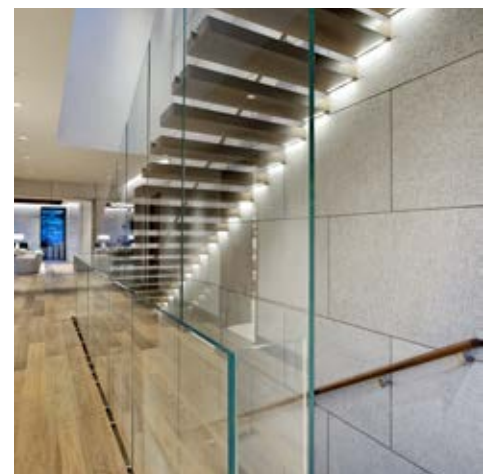

UNITED STATES OF AMERICA
TEL +1 206 709 3000

rhodes-stone.com
info@rhodes-stone.com

AUSTRALIA
TEL +61 3 8199 9555

CHINA
TEL +86 592 533 0273